

ESM500

500Kg Surface Mount Electromagnetic lock

EN

PRODUCT PRESENTATION

- **UL Listed.**
- **Holding force:** 500kg.
- **Surface mount.**
- **Stainless Steel**
- **Waterproof and high corrosion resistance**
- **No mechanical wear.**
- **Ease of installation.**
- **Fail safe (Door unlocked when power off).**
- **No residual magnetism.**
- **Built-in varistor:** Built-in electronic protection to eliminate back EMF.

- Dimensions: 9 x 2.5 x 1.65 in. (230 x 63 x 40mm)
- Armature dimensions:
7.3 x 2.5 x .5 in. (185 x 61 x 12mm)
- Power supply: 12/24V dc.
- Power absorption:
 - 12 V DC = 500mA,
 - 24 V DC = 250mA.

WEEE & RoHS

EC certification

IP42

Recommended power supplies



INSTALLATION

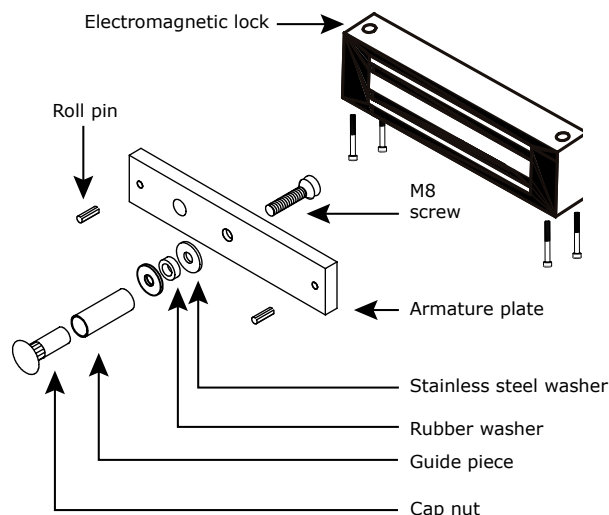

PACKAGE CONTENTS

Magnetic lock	Armature plate	Cap nut	Guide piece	Nut M6	Screw M6 x 60
1	1	1	1	4	4
Screw with washer 8x35	Roll pin 5x16	Washer 10x22	Rubber washer 9x15	5mm key	Installation Manual
1	2	2	1	1	1

ELECTRICAL CONNECTIONS

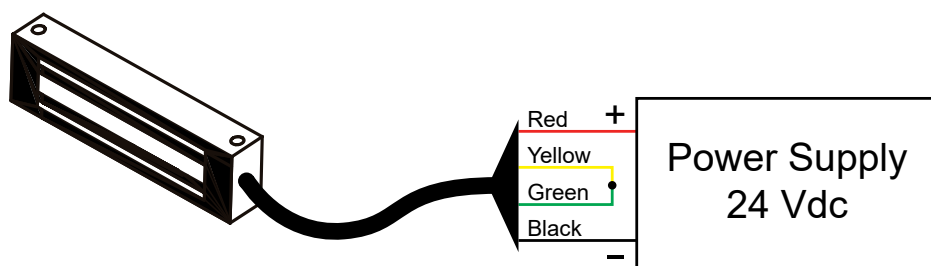
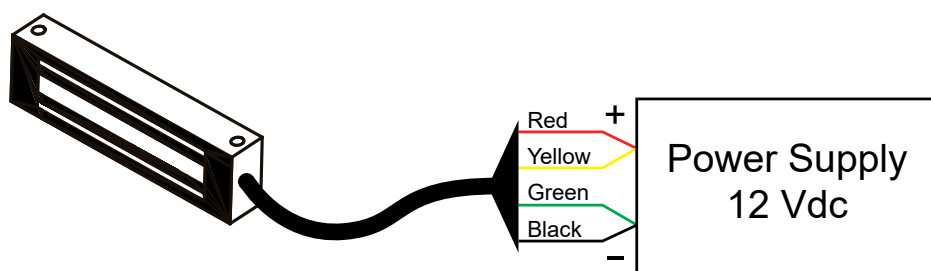

IMPORTANT NOTE

Make sure that the magnet and the armature meet evenly over their entire mating surfaces.

The Armature plate must be able to pivot slightly about its center mounting screw to compensate for any door misalignment.