

KRYPTO

HIGH SECURITY SOLUTION

K1

KRYPTO
High-Security Card Reader

CDVI's economical KRYPTO K1 card reader makes high security easy!

KRYPTO K1 Mifare DESFire EV2 readers combined with CDVI EV2 credentials work right out of the box. No tedious and complicated programming required!

Factory-programmed, industry-unique secure CDVI protocol and encryption keys ensure end-to-end encryption between the card, reader and A22K door controller.

KRYPTO K1 – High Security Made Easy!

- Compatible with ATRIUM A22K controller
- FULLY secure RS-485 connection (4 wires)
- Reads 13.56 MHz Mifare Classic and DESFire EV1/EV2 credentials
- OSDP-2 compatible
- NFC mobile credential ready
- Up to 2" (5 cm) read range
- Power requirements: 12 VDC
- Current consumption : 200mA

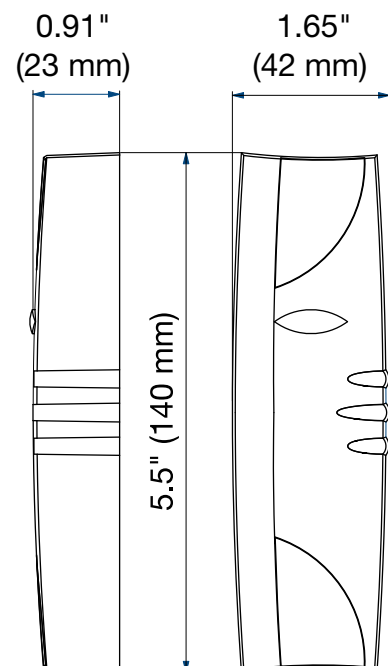

WIRING DIAGRAM

A22K CONTROLLER

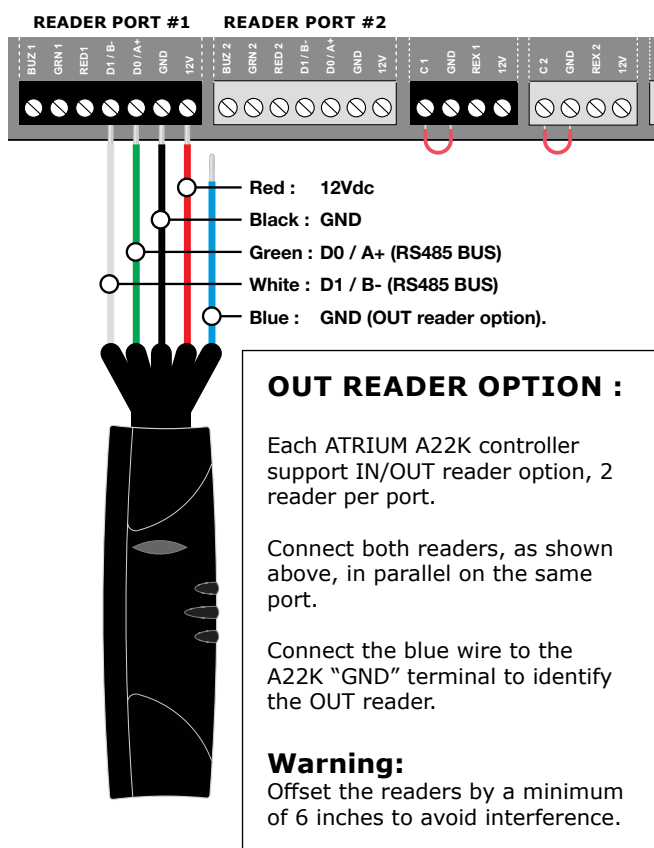

It is recommended to use twisted pair wiring as shown below between the reader and the A22K ATRIUM controller.

Furthest reader can be installed up to 4000 ft (1220 m) from the A22K controller (AWG 22 cable).



CABLE CONNECTIONS

Wire Leads	Connect to A22K Reader Port
Red	12 VDC
Black	GND
Green	D0 / A+
White	D1 / B-
Blue	GND (OUT reader option)

LED STATUS INDICATORS

Here are the LED status when connected to an A22K ATRIUM controller :

LED State	Buzzer	Description
Steady blue	-	Standby (door secure)
Turn green for 5 sec.	Chirp beep	Access granted
5 rapid red blinks	Steady beep for 3 sec.	Access denied
Flashing blue	-	Reader compromised (lost its encryption key)
Blinks green every 3 sec.	-	Door unlock schedule
Flashing red	Steady beep	Door forced alarm
Flashing red	Beep every 2 sec.	Door open too long pre-alarm
Flashing red rapidly	Fast beep	Door open too long alarm

Note:

Door output timings such as; unlock time (access granted), door open too long pre-alarm and door open too long alarm, can be modified in the ATRIUM software "Door Properties" window.

MOUNTING

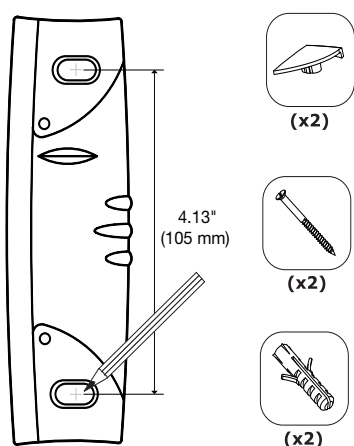

- Connect wires as shown above. See "Wiring Diagram".
- Once level and aligned, mark the mounting holes of the reader.
- Drill the fixing screw holes. Use provided anchors if required.
- Once the card reader mounted to the wall, put the screw cover caps on the reader.