



Radium Remote control



1 - INTRODUCTION

The remote control RADIUM R1 - R2 - R2T - R4 is a 1-2-4 buttons key chain style transmitter, operating at 433,92 MHz. It has been designed for the control of automatic closing systems and anti-burglar systems, thanks to its very high security coding system (KeeLoq® Hopping code). The code sent by the transmitter changes at each activation, avoiding any scanning and copying risk. A special algorithm keeps the transmitter and receiver synchronized. The transmitter can be equipped with a passive tag (see table for the reference). The CR 2016 lithium batteries of the transmitter have a shelf life of about 6 months. The product fully complies with Part 15 of FCC Regulations and the European Directives 2006/95/CE, 2004/108/CE, 99/05/CE.

2 - TECHNICAL SPECIFICATIONS

Operating frequency:	433,92 MHz
Number of buttons:	1-2-4
Battery:	2 x 3V lithium CR2016
Battery life:	18 to 24 months
Security code:	KeeLoq® Hopping code
Number combinations:	2exp64
Operating temperature:	-20°F to +131°F
Overall dimensions:	2.83" x 1.4" x 0.47"
Weight:	0.49 oz. (14 gr.)

3 - PRODUCT RANGE

P/N	Description	Tag (125 KHz)
R1	1 Button Remote	-
R1H	1 Button Remote	HID
R1P	1 Button Remote	Paradox
R1C	1 Button Remote	CDVI
R2 / R2T	2 Buttons Remote	-
R2H / R2TH	2 Buttons Remote	HID
R2P / R2TP	2 Buttons Remote	Paradox
R2C / R2TC	2 Buttons Remote	CDVI
R4	4 Buttons Remote	-
R4H	4 Buttons Remote	HID
R4P	4 Buttons Remote	Paradox

4 - NUMBERING

Each transmitter is manufactured and sold with a different factory-set serial number.

6 - PROGRAMMING

The transmitter must be programmed into your system memory.

7 - OPERATION

A - Firmly depress the button until the small red BLUE illuminates.

B - After the LED has illuminated, release the button.

If the device you are attempting to activate does not respond, repeat steps A and B or consult section 9 (Troubleshooting) of this manual.

8 - BATTERY ACCESS

To access the battery slide out the battery door as shown in figure. Slide out the 2 old batteries and replace them with the new ones [CR2016] respecting the polarity, with the positive (+) side upward.

NOTE: Please dispose of the batteries properly according to local laws and regulations. Test proper battery installation by verifying that the LED illuminates when the button is pushed.

9 - TROUBLESHOOTING

PROBLEM	SOLUTION
The system does not receive the transmitter signal. The transmitter LED is ON	Check to verify if the remote is programmed into your system
The operating range is reduced The transmitter LED is blinking	Low battery : replace batteries
The system does responds. The transmitter LED is OFF	Battery empty : replace batteries



Manufactured by:
CDVI Wireless
Made in ITALY

IS-T15CDUK Rev. 1 on 2/4/2014

5 - MAIN COMPONENTS

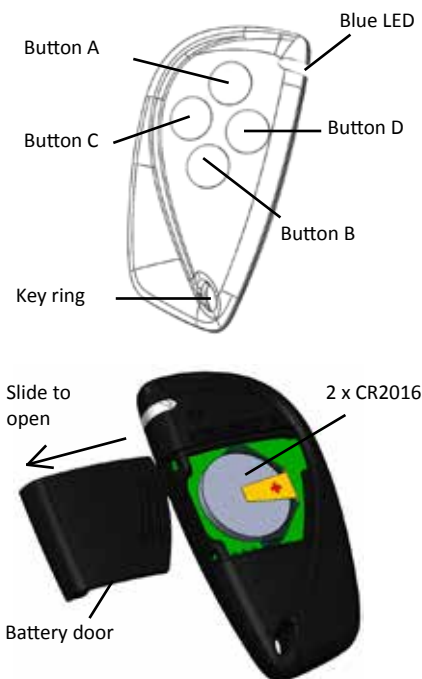

FCC ID : PWJS3RT

This device complies with Part. 15 of the FCC Rules Operation is subject to the following two conditions:

- (1) This device may not cause harmful interference, and
- (2) this device must accept interference received, including interference that may cause undesired operation.



This EUT is in compliance with MPE for general population / uncontrolled exposure limits and it had been tested in accordance with the measurement methods and procedures specified in FCC 47 CFR § 1.1310 and 2.1091 .

To satisfy FCC RF exposure requirements for mobile transmitting devices, a separation distance of 20 cm or more should be maintained between the antenna of this device and persons during device operation. To ensure compliance, operations at closer than this distance are not recommended. The antenna used for this transmitter must not be co-located in conjunction with any other antenna or transmitter.

Notice

Any changes or modification to CDVI equipment not expressly approved by CDVI could void the manufacturer's warranty.

WARRANTY

The warranty period for this product is 60 months, beginning from the manufacturer date. During this period, if the product does not work correctly, due to a defective component, the product will be repaired or substituted at our discretion. The guarantee does not cover the plastic container integrity. After-sale service is supplied at the factory.