

DATA SHEET	10512100
EPIC® H-A 3 MTgv	Valid from: 16.07.2015

Description

- Innovative metal and plastic housing design
- Housing in plastic or metal version. For power supply in the smallest possible space



General characteristics

Series	H-A 3
Version	Hood PG 11
Locking mechanism	bolts for single lever
Cable entry	straight
Protection	IP 65 (locked)
Temperature range	-40°C to +100°C, short-term up to +125°C

Materials and surfaces

Housing, base material	zinc die-casting
Housing, surface	powder-coating, grey

Approvals

VDE-Approval, VDE-REG.-Nr.	B437
----------------------------	------

Standard

Product Standard	IEC 61984
------------------	-----------

DATA SHEET	10512100
EPIC® H-A 3 MTgv	Valid from: 16.07.2015

Drawings

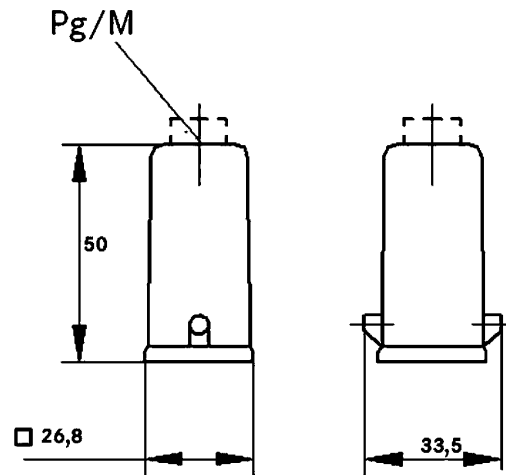

Industrial machinery and plant engineering



Mechanical resistance



Robust



Waterproof

Info

Compact, robust metal housings size H-A 3

Application range

Machine and equipment manufacturing
Control engineering
Electronic laboratory

Remark

Photographs are not to scale and do not represent detailed images of the respective products.

Creator: MANA2/PDP Released: IVSE1/PDP	Document: DB10512100EN Version: 00	Page 2 of 2
---	---------------------------------------	---------------------------