

Current Transformers—333mV

Submetering Solutions for Accurate Measurement & Verification

For use with VerifEye™ EMH+, Series 4000, 4100, 7000 and 7100 Meters only



DEFINITION

Leviton 333mV Current Transformers (CTs) support the VerifEye EMH+, Series 4000, Series 4100, Series 7000, and Series 7100 lines of revenue-grade meters and help meet all measurement and verification-based opportunities, including smart metering and LEED rating achievement. Designed as part of a simple and effective process for accurately capturing measurements of power consumption, CTs are easy to specify and install for new construction and retrofits.

The better the equipment, the better the measurement. Leviton meters utilize highly accurate current transformers for revenue-grade performance certified to ANSI standards. Solid core CTs are standard for high-quality, long-term accuracy and reliability. For added safety, all Leviton current transformers come with built-in voltage suppression devices that prevent hazardous voltages from developing on CT secondaries should they become disconnected from a meter with load current present. Leviton CTs are UL and cUL listed devices.

SOLID CORE

Leviton solid core CTs are cost effective and less susceptible to damage during installation. Solid core CTs slip over power lines to measure the electrical current flowing through the line. The CT “secondary” wires connect to the meter facilitating power and energy calculations. They are compact and cost effective. Solid core CTs are accurate (0.2% maximum error). For installation, power must be de-energized and the circuit opened in order to slip the CT over the power line.

SPLIT CORE

Split core CTs can be disassembled or ‘split’ into halves eliminating the need to turn power off and open the circuit during installation. This time-saving installation is ideal for critical loads that cannot be disconnected.

Leviton split core CTs are designed to close and lock to ensure a secure, fast and precise installation with no need for time-consuming tie wraps and no worries about improper seating or core separation.

- Indoor type for measurement category Class IV, accessory equipment for energy meters
- Designed to meet the requirements of UL916 plus CSA C22.2 No. 61010-1
- Suitable for installation on 600V uninsulated bus duct

ROGOWSKI COIL

Rogowski Coil CTs are flexible rope style CTs with high amperage ranges from 50-5000A. The coil opens at the connector junction for fast and easy installation into an existing cable or bus bar. The Rogowski Coil's flexible core is ideal for tight enclosures and odd-sized conductors with three length options: 12”, 16”, 18” and 24”. Rogowski Coil CTs are for use with VerifEye Series 4000, 4100, 7000, and 7100 Industrial ModBus and BACnet Meters.

Note: Leviton recommends solid core transformers (CTs) for revenue-grade accuracy. Split core CTs are also available upon request for applications where power cannot be interrupted during installation. The 100-5,000A split core and 50-5000A Rogowski Coil CTs offer +/-1.0% accuracy.

APPLICATIONS

Use current transformers in commercial, institutional, industrial and government applications to support:

- Load profiling and benchmarking
- AMR/BAS/BMS/EMS integration
- Power quality analysis
- Usage aggregation
- Tenant cost allocation
- Measurement and verification
- Net metering
- Energy conservation and cost reduction
- Green building initiatives and government mandates

PRODUCT DATA



DIMENSIONAL DIAGRAMS — FOR USE WITH EMH+ AND SERIES 4000, 4100, 7000 & 7100 INDUSTRIAL MODBUS & BACnet METERS

SPLIT CORE

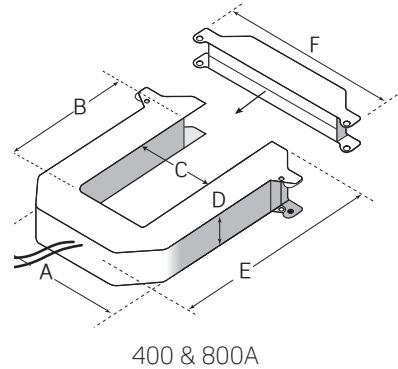
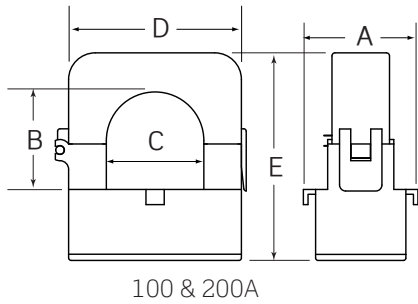

CT Size	A	B	C	D	E	F
50A:333mV	1.16" (29.4mm)	0.4" (10.2mm)	0.4" (10.2mm)	1.04" (26.4mm)	1.64" (41.7mm)	-
100A:333mV	1.5" (38.10mm)	0.8" (20.32mm)	0.7" (17.78mm)	1.6" (40.64mm)	2.1" (53.34mm)	-
200A:333mV	1.5" (38.10mm)	1.25" (31.75mm)	1.25" (31.75mm)	2.25" (57.15mm)	2.8" (71.12mm)	-
400A:333mV & 800A:333mV	4.9" (124.46mm)	2.29" (58.16mm)	2.25" (63.5mm)	1.2" (30.48mm)	5.2" (132.08mm)	6.0" (152.40mm)

SOLID CORE—

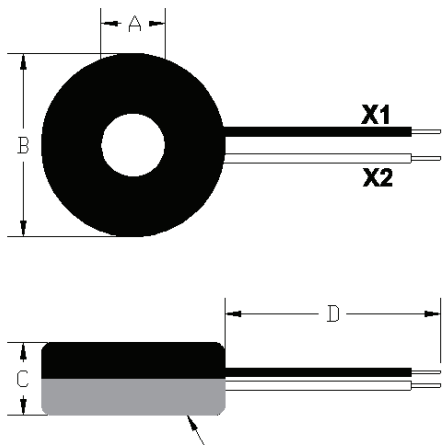

CT Size	A	B	C	D
100A 333mV	0.72" (18.3mm)	2.06" (52.3mm)	0.82" (20.8mm)	48.00" (1219mm)
200A:333mV				
400A:333mV	1.50" (38.1mm)	3.60" (76.2mm)	1.38" (34.9mm)	48.00" (1219mm)

ROGOWSKI COIL*

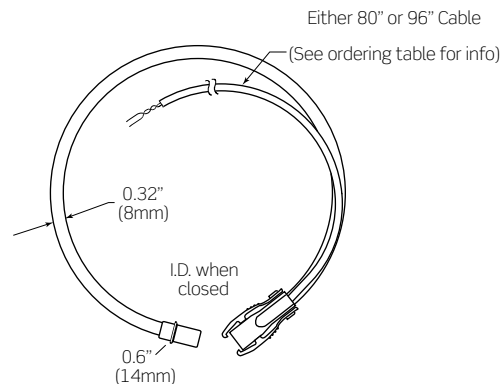

LENGTH	INSIDE DIAMETER WITH CLOSED CONNECTOR
12" (305mm)	3.85" (98mm)
16" (406mm)	4.5" (115mm)
18" (458mm)	5.75" (147mm)
24" (610mm)	7.65" (195mm)

* Rogowski Coils are designed for use with specific meters. See the Ordering Information chart for meter compatibility.

PRODUCT DATA



ORDERING INFORMATION

NOTE: Meters sold separately

AMP	OPENING DIMS.	LEAD LENGTH	CAT. NO.	ACCURACY	DESCRIPTION
SOLID CORE CTs FOR USE WITH ALL 333mV METERS					
100	0.76"	144"	CDV01-K17	0.2%	Solid Core
200			CDV02-K17		
400	0.98"		CDV04-K25		
SPLIT CORE CTs FOR USE WITH ALL 333mV METERS					
50	0.4"	96"	CTV5X-WA4	0.5%	Split Core
100	1.6" x 2.1"	48"	CTV01-K21		
200	2.2" x 2.8"		CTV02-K21		
400	6.0" x 5.2"		CTV04-K40		
800			CTV08-K40		
ROGOWSKI COIL CTs FOR USE WITH SERIES 4000 & 4100 METERS ONLY					
50-5000A	12"	96"	CRV50-K62	1.0%	Rogowski Coil CT
50-5000A	18"		CRV50-K93		
50-5000A	24"		CRV50-KC2		
ROGOWSKI COIL CTs FOR USE WITH SERIES 7000 & 7100 METERS ONLY					
5-4000A	16"	80"	CRV50-LR2	0.2%	Rogowski Coil CT
5-4000A	24"		CRV50-LR4		

NOTE:

- 333mV solid and split core CT leads can be extended to 300'
- Rogowski CT leads can be extended up to 20'

The following products are also part of the Leviton line of VerifEye integrated metering solutions:

Mini Meters
 Series 1000 Meters
 Series 2000 Meters
 Series 3500 Meters
 Series 4000 & 4100 Industrial ModBus & BACnet Meters
 Series 7000 & 7100 Meters
 Series 8000 Meters
 Multiple Meter Units (MMUs)
 EMH+ Integrated Meter & Hub
 Building Manager Online (BMO) 3.0

Current Transformers—333mV

Leviton Manufacturing Co., Inc. Energy Management, Controls and Automation

20497 SW Teton Avenue, Tualatin, OR 97062 **tech line** (6:00AM-4:00PM PT Mon-Fri) 800-959-6004 **fax** 503-404-5594

©2019 Leviton Manufacturing Co., Inc. All rights reserved. Subject to change without notice.

Leviton Manufacturing Co., Inc. Global Headquarters

201 North Service Road, Melville, NY 11747-3138 **tel** 800-323-8920 **fax** 800-832-9538 **tech line** (8:30AM-7:00PM ET Mon-Fri) 800-824-3005

Leviton Manufacturing Co., Inc. Energy Management, Controls and Automation

20497 SW Teton Avenue, Tualatin, OR 97062 **tel** 800-736-6682 **fax** 503-404-5594 **tech line** (6:00AM-4:00PM PT Mon-Fri) 800-959-6004

Visit our Website at: www.leviton.com/verifeye

©2019 Leviton Manufacturing Co., Inc. All rights reserved. Subject to change without notice.

LES-G-10373/D19/AA