

Dynamic Cable Manager

SPECIFICATIONS

The dynamic cable manager shall reduce the strain that static mounts experience during the opening and closing of electrical cabinet doors. The cable bundle shall remain stationary with a ball-and-socket tether transferring and absorbing the strain during assembly, installation, and transportation. The mounts shall be manufactured from a Nylon 6.6 material and include rubber-based and high bond adhesive options.



TECHNICAL INFORMATION

Part Number:	ABDCM30-A-C	ABDCM30-AV-C
Mount Material:	Nylon 6.6	Nylon 6.6
Color:	White	White
Adhesive Type:	Rubber-based	High-Bond Acrylic
Adhesive Application Temperature Range:	-20°F to 120°F (-29°C to 49°C)	-31°F to 185°F (-35°C to 85°C)
Adhesive Tack Strength:	0.63 lbs (286 g)	1.25 lbs (567 g)

KEY FEATURES AND BENEFITS

Unique mount design:	Transfers the dynamic load of the bundle away from the edge of the mount; preventing mount from peeling off panel surface
Ball-and-socket tether:	Retains position of bundle relative to hinge while opening and closing panel door(s), reduces normal load by up to 70% with bundles over three-quarters of an inch, and reduces peak shear loads by up to 75% compared to typical static mounts; eliminating the risk for potential shocks and shorts that could damage internal components and extending service life of cable bundles and mounts
Universal slot design:	Permits use of any cable tie up to 50 lbs. minimum loop tensile strength; providing design flexibility

APPLICATIONS

The Panduit dynamic cable manager is a reliable and cost-effective solution for securing cable bundles in control panels that have hinged access into the panel box, which also ensures continuity of the related systems in the physical infrastructure. These mounts are well suited for use with control panels featuring control lights, touch pads, and switches in the panel door. The unique mount allows the panel door to be easily opened and closed and extends the service life of the adhesive in applications where bundle movement is unavoidable.

Dynamic Cable Manager

1.12" x 1.12" **ABDCM30-A-C**
(28.4mm x 28.4mm)
mounting base: **ABDCM30-AV-C**

Recommended Cable Ties

Use with **Pan-Ty[®]** or **Dome-Top[®]**
Barb Ty Cable Ties up to Standard
cross section (50 lbs. minimum
loop tensile strength)

ORDERING INFORMATION

Part Number	Used With Cable Ties	Mounting Method	Length A		Width B		Overall Width C		Height D		Material	Color	Std. Pkg. Qty.	Std. Ctn. Qty.
			in.	mm	in.	mm	in.	mm	in.	mm				
ABDCM30-A-C	Miniature, Intermediate, Standard	Rubber Adhesive	1.12	28.4	1.12	28.4	1.98	50.3	0.66	16.8	Nylon 6.6	White	100	1000
ABDCM30-AV-C		High Bond												

ENGINEERING DRAWINGS

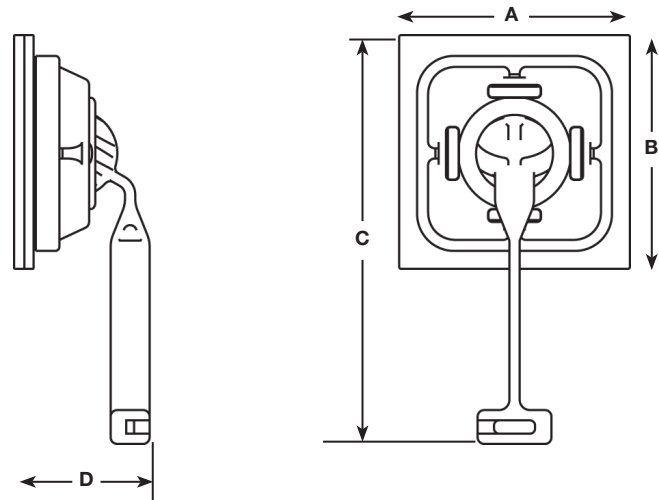

TYPICAL INSTALLATION

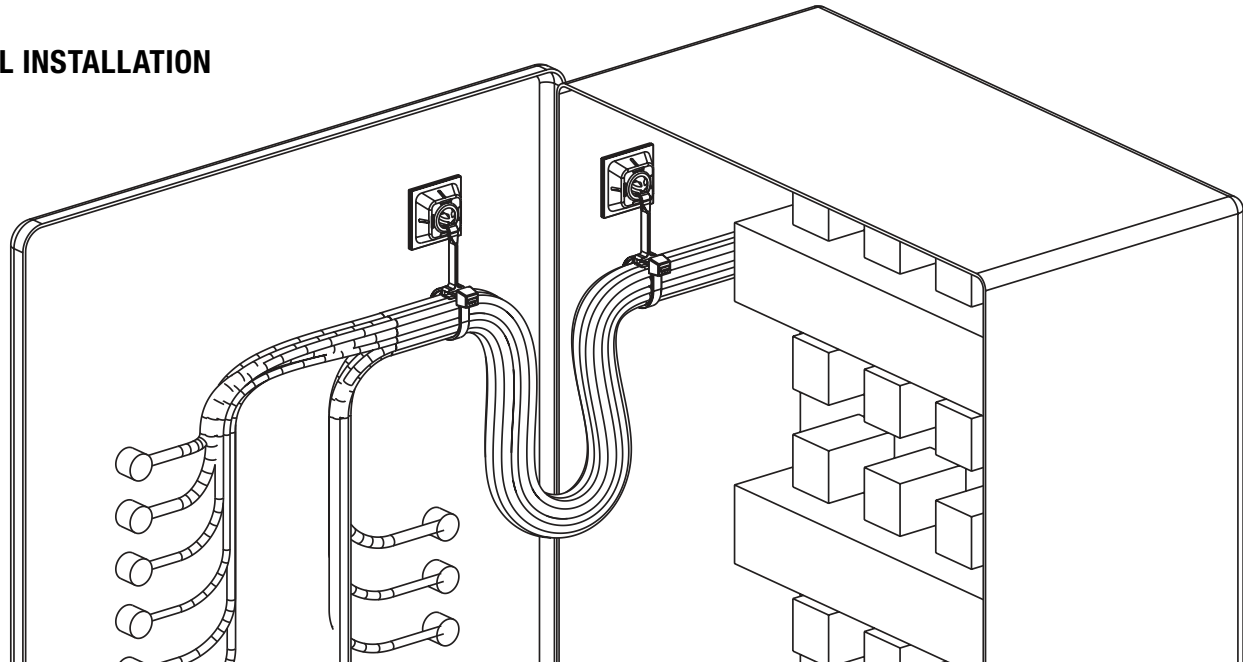

WORLDWIDE SUBSIDIARIES AND SALES OFFICES

PANDUIT US/CANADA Phone: 800.777.3300	PANDUIT EUROPE LTD. London, UK Phone: 44.20.8601.7200	PANDUIT SINGAPORE PTE. LTD. Republic of Singapore Phone: 65.6305.7575	PANDUIT JAPAN Tokyo, Japan Phone: 81.3.6863.6000	PANDUIT LATIN AMERICA Guadalajara, Mexico Phone: 52.33.3777.6000	PANDUIT AUSTRALIA PTY. LTD. Victoria, Australia Phone: 61.3.9794.9020
--	---	---	--	--	---

For a copy of Panduit product warranties, log on to www.panduit.com/warranty



For more information
Visit us at www.panduit.com
Contact Customer Service by email: cs@panduit.com
or by phone: 800.777.3300

© 2024 Panduit Corp.
ALL RIGHTS RESERVED.
FRSP38-WW-ENG
3/2024