

SALES BULLETIN: SS-126

RT-200 FIRMWARE UPDATE ADDS TIME DELAY FEATURE



RT-200 ASTRONOMICAL TIME SWITCH

Wattstopper's RT-200 offers both Astronomical and Standard timeclock abilities that can automatically control lighting or other loads. Since its launch, the RT-200 has been a preferred product for applications where clients want a simple, easy to set up single channel timeclock with the ability to schedule:

- Standard time events (7:00am On – 6:00pm Off), or
- Astro events (Dusk On – Dawn Off), or
- A mix of both standard and astro events (Dusk On – 11:00pm Off)

The RT-200 can replace a standard single-pole wall switch and immediately enhance energy savings and security. While most often used in residential applications, the RT-200 works on 120V or 277V circuits allowing it to also be used in many commercial applications.

As a leading provider of solutions used to meet Energy Codes, Wattstopper continually monitors the codes and updates our products. Previously the RT-200 met the exterior residential requirements in California's Title 24 Building Code, but a language change in 2019 has required a product enhancement. The latest 2019 version of the code states in Section 150.0(k)3A:

For single-family residential buildings, outdoor lighting permanently mounted to a residential building, or to other buildings on the same lot, shall meet the requirement in item i and the requirements in either item ii or item iii:

- Controlled by a manual ON and OFF switch that permits the automatic actions of items ii or iii below; and*
- Controlled by a photocell and either a motion sensor or an automatic time switch control; or*
- Controlled by an astronomical time clock control.*

Controls that override to ON shall not be allowed unless the override automatically returns the automatic control to its normal operation within 6 hours.

The RT-200 met the above code except for the last line (bolded for emphasis). If an RT-200 was set as an astronomical timeclock and was overridden On, it would not reset automatically within six hours.

RT-200 ENHANCEMENTS

Wattstopper is pleased to announce that we have made a running modification to enhance the operation of the RT-200 to meet the above code requirement. Specifically:

- We've added a new 6 hours max countdown (time delay) feature so if a user overrides a light On by pressing the RT-200's button, it will stay on for that amount of time and then return back to its schedule mode automatically.
- Product will ship in a default 2 hour countdown mode to help our customers save additional energy. The countdown can be set to none (which will act like the original RT-200), 5 min, 10 min, 15 min, 30 min, 1 hour, 2 hours (default), 3 hours, 4 hours, 5 hours, or 6 hours.
- We have designed this time delay function to be intelligent so that if the light should be On at the end of the time delay because of schedule events that have occurred since the button was pressed, the light will not turn Off – it will stay on. Note that this is the same functionality used in our popular LP-8 Peanut Panel, a popular choice when up to eight high amperage loads must be controlled.

This modification means:

- RT-200 meets CA Residential Exterior Energy Code when the Countdown function is used
- RT-200 meets CA and many other Non-Residential Exterior Energy Codes for Timeclocks
- RT-200 can meet CA and many other Non-Residential Interior Energy Codes when there is a requirement for a maximum 2-hour time delay. (See *Note* above ordering info)

The below graphic provides examples of the intelligent override feature of the RT-200 in operation:

- If countdown timer ends outside of a "Scheduled On time", the load turns Off
- If countdown ends during the load's "Scheduled On time", the load will remain On

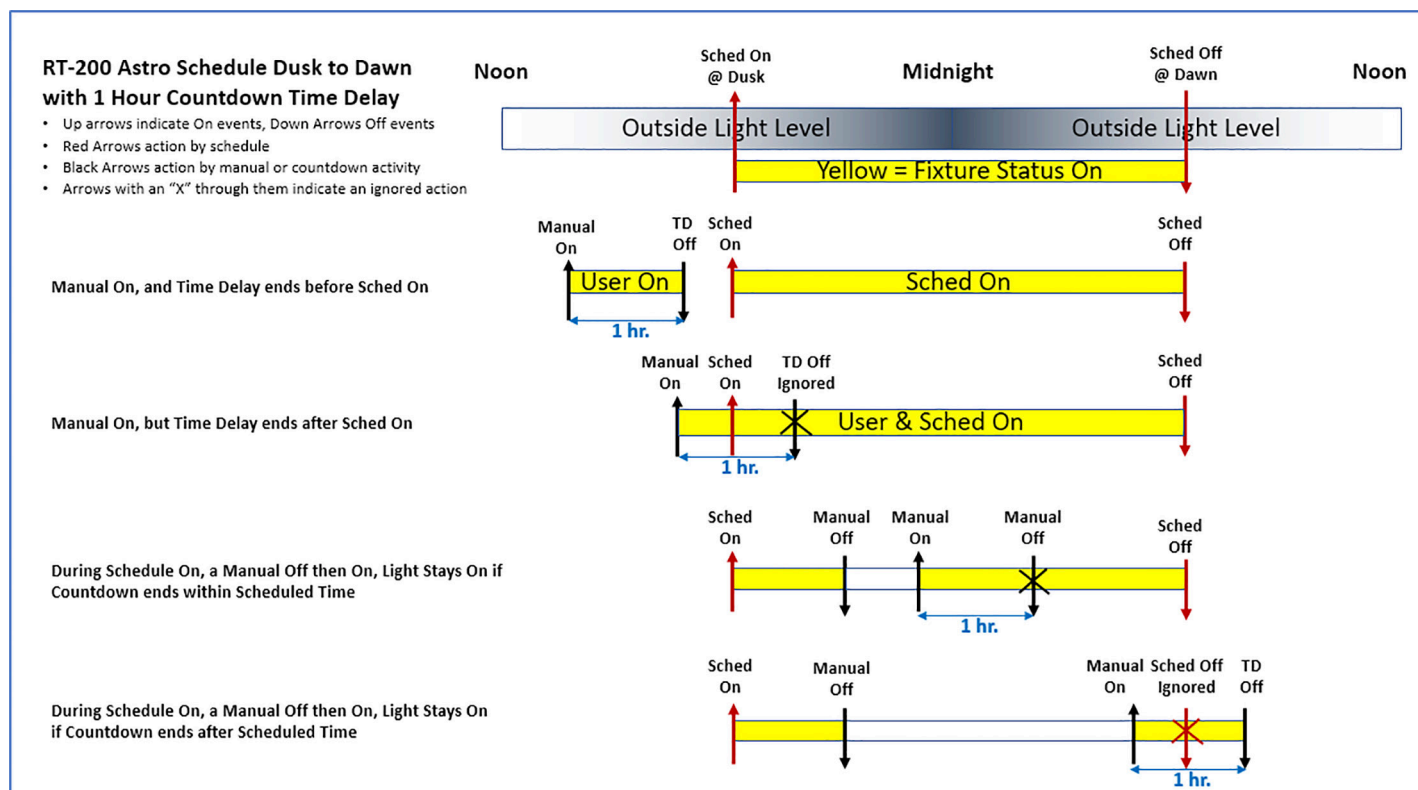

INSTALLATION INSTRUCTION UPDATES

The following information has been added to the RT-200’s Installation Instructions to show how the Countdown setting can be changed from the new default 2 hour setting to 15 minutes (or “None” or any other optional setting) in the user interface screen.

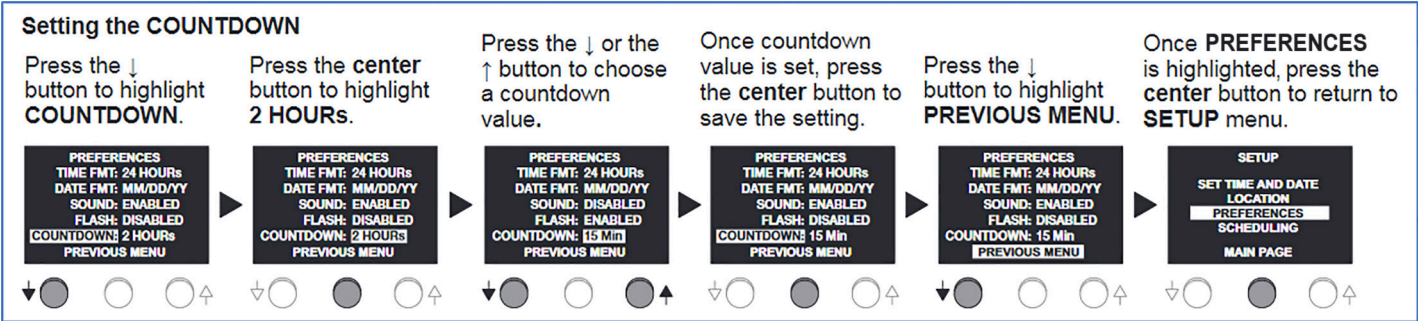

NOTE: The RT-200 does not have a Holiday Function. Energy Codes that require the ability to enter in specific Holiday Dates would not be met with this device. Codes that require Holidays to have no events, but do not require speciic dates to be set, can be met with this device.

ORDERING INFORMATION

Catalog #	Description	Voltage
<input type="checkbox"/> RT-200	Astronomical Time Switch	120/277 VAC, 50/60Hz